

1. Product Name

Crackbond WS200B Water Stopping Hydrophobic Polyurethane Grout

2. Company

Adhesives Technology Corp.
450 East Copans Road
Pompano Beach, FL 33064
Ph: (800) 892-1880 or (954) 782-2221
Fx: (800) 362-3320 or (954) 782-2499
E-mail: info@atc.ws
Web Address: www.atc.ws

3. Product Description

GENERAL DESCRIPTION

Crackbond WS200B is a custom formulated flexible hydrophobic polyurethane waterstop material packaged in two component cartridges. It is a solvent-free, methyldiphenyl isocyanate (MDI) based polymer, which will react with water. When cured in a free-rise situation, it will expand to about 750 percent of its original volume and yield to a 7 – 8 lb per cubic foot (pcf) foam. Often selected by professionals to stop water leaks with low to high flow rates.

BASIC USE:

Crackbond WS200B is used for stopping water infiltration in the following applications:

Concrete crack injection

- Flowing water leaks
- Dry cracks
- Wet cracks
- Honeycombed concrete areas

Municipal and Utility Facilities

- Cracks and joints
- Wastewater containment tanks

Underground Parking Garages

- Expansion joints
- Sealing pipe openings
- Beam joints

Concrete Dams & Powerhouse Galleys

- Flowing water leaks
- Cracks and joints

The unique applications and places where **Crackbond WS200B** is used exposes the product to a wide range of weather conditions and temperatures. Temperature of the chemical affects the viscosity (liquid thickness) of the material.

| Temperature Effects On Viscosity | | |
|----------------------------------|-----------------|--------|
| Temperature | Viscosity (cps) | |
| | Part A | Part B |
| 55°F (12.8°C) | 1,000 | 1,800 |
| 77°F (25°C) | 500 | 650 |
| 89°F (31.7°C) | 375 | 475 |

| Temperature Effects on Reaction Times | | | |
|---------------------------------------|---------------------|-------------|-------------|
| Temperature | Water / Grout Ratio | | |
| | 55°F (12.8°C) | 77°F (25°C) | 95°F (35°C) |
| Cream Time | 100 seconds | 50 seconds | 30 seconds |
| Top of Rise Time | 3.5 minutes | 3 minutes | 2.3 minutes |
| Tack Free Time | 10 minutes | 9 minutes | 9 minutes |

Cream Time: The time when the material first starts to react.

Top of Rise Time: The time the material has reached the full expansion.

Tack Free Time: The time at which the material can be touched without feeling tacky.

SIZE/PACKAGING

Cartridge Sizes: **Crackbond WS200B** is available in:

- 22 oz cartridges; part number: A22-WS200B

SHELF LIFE: 12 Months

STORAGE STABILITY: Product must be stored in unopened containers at 40°F – 95°F.

4. Technical Data

| Physical Properties (uncured) | | | |
|-------------------------------|---------------|---------------|-------------|
| | Part A | Part B | Test Method |
| Color | Pale Yellow | Clear | Visual |
| Specific Gravity | 1.04 | 1.044 | ASTM D891 |
| Viscosity @ 77°F (25°C) | 450 – 550 cps | 570 – 670 cps | ASTM D4878 |
| Solids | 100 Percent | | |

| Physical Properties (Cured) | | | |
|-----------------------------|-----------|---------|-----------|
| | | | |
| Tensile strength | 55 | Psi | ASTM D412 |
| Elongation | 140 | Percent | ASTM D412 |
| Pot-Life at 77°F | 10 | Minutes | |
| Density | 10 – 15 | Pcf | In-house |
| Die-C tear | 8 | Pli | In-house |
| Toxicity | Non-toxic | | |

Adhesives Technology Corp.

5. Installation Procedures - To achieve desired results, carefully follow the procedures below!

Step 1. Drilling

Drill a series of staggered holes along the full length of the leaking crack. Space the holes 4 to 6 inches apart starting at the bottom. Insert the drill at a 45-degree angle toward the crack.

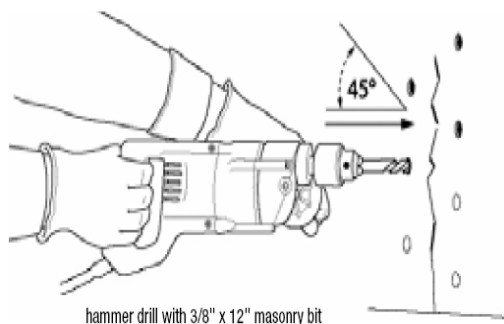

Step 4. Injecting Crackbond WS200B

Working from bottom to top, insert the nozzle into the first hole and squeeze the dispenser trigger three to four times. Continue dispensing until a milky liquid appears. Depending on the size of the leaking crack, one cartridge should be sufficient to treat approximately 8 feet.

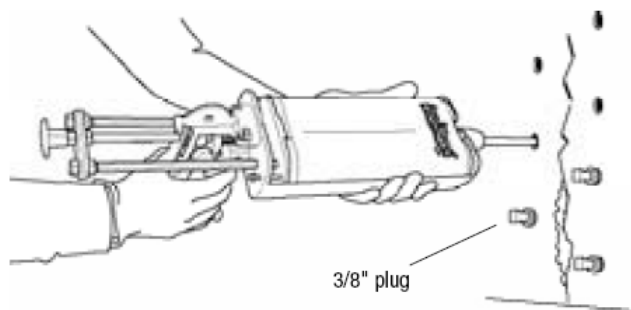

Step 2. Flushing with water

Attach the valve and nozzle supplied with the kit to a garden hose. (A pump sprayer may also be used to supply water.) Starting at the bottom, flush each hole while adjusting the water to a low-pressure stream using just enough water to flush the debris from each hole and to wet the entire crack.

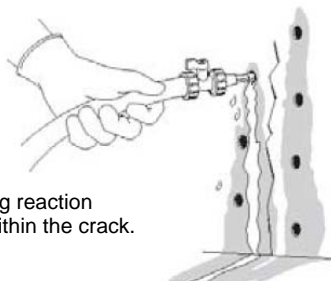

Tip:

Water promotes a foaming reaction of Crackbond WS200B within the crack.

Step 5. Inserting plugs

When a milky liquid appears insert a threaded plug into the hole to contain the reacting polyurethane. Allow 30 minutes before pulling out the reusable plugs. If any water reappears, you may need to repeat Steps 1-5 until the crack is repaired.

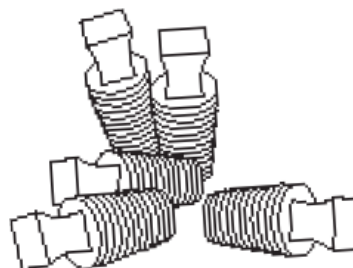

Tip:
Plugs retain the reacting grout within the crack for easier cleanup.

Step 3. Assembling the cartridge

Shake cartridge well before installing nozzle. Remove cap and plug from cartridge. Attach mixing nozzle with retaining nut. Place the cartridge in the dispensing gun.

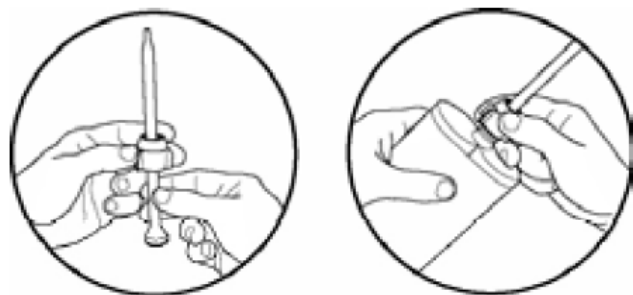

Step 6. Cleaning and finishing

With a flat-bladed tool, remove any excess grout on the exterior of the crack. Patch any holes using a putty knife, with Miraclebond or similar patching material.



Note: Crackbond WS200B is an Isocyanate Prepolymer mixture and may cause lung damage. May cause eye, skin, and respiratory tract irritation. May cause allergic respiratory reaction. Harmful if inhaled. May cause skin reaction. Toxic gases/fumes given off during burning or thermal decomposition; prior to using the Crackbond WS200B product, please consult the material safety data sheet for proper handling instructions. **Precautions:** Crackbond WS200B is intended to be used by trained professionals with the proper equipment.

- Wear protective gloves, clothing, goggles, hearing protection for noise reduction and hard hats for falling debris.
- Do not eat, drink or smoke while in active contact with Crackbond WS200B (or other chemicals).
- Avoid skin contact.
- Wash hands thoroughly with soap and cool water. Never wash the skin with a solvent.
- Anyone experiencing difficulty breathing when working with these materials or showing an allergic reaction should seek fresh air immediately and consult a physician if symptoms persist.

Depending on the scope of the project, it may be advisable to consult a manufacturer's representative during installation.

Sample Specification – Repair material shall be a two-component, Hydrophobic polyurethane that cures when mixed with water. It should be supplied in a dual component, side by side cartridge and mixed with a static mixer nozzle (supplied by the manufacturer). The material must have a viscosity of 450 – 700 cps, a tensile strength of 55 psi and an elongation of 140%. Repair material shall be **Crackbond WS200B** manufactured by Adhesives Technology Corp., Pompano Beach, Florida.

BUILDING CODES

Installation of Crackbond Adhesives must comply with applicable local, state and national code requirements.

SITE CONDITIONS

Material shall be delivered in original unopened containers and stored in a dry environment at a temperature between 40° and 95°F.

PRECAUTIONS

- Wear safety glasses
- Avoid prolonged contact with skin.
- Keep out of reach of children
- Do not take internally
- If Ingested seek medical attention immediately.
- Eye contact. Flush with water for at least 15 minutes. Call a physician immediately.

5. Availability and Cost

AVAILABILITY

Crackbond Adhesives are available through select distributors who can provide you with all of your construction needs. Please contact Adhesives Technology Corp. at (800) 892-1880 for a distributor near you.

COST

Cost information is available from your local distributor.

6. Warranty

All warranties of the product listed herein, in the corresponding ATC catalog, and in any other current literature, expressed or implied, including warranties of merchantability and fitness for a particular purpose are specifically and expressly excluded, with the following exception: At its sole discretion, ATC will repair or replace any product which it considers to be defective in material or workmanship, excepting normal wear and tear within sixty (60) days from the date of purchase from ATC. ATC shall not be liable for any injury, loss or damage, direct, indirect, incidental or consequential or arising out of use of, misuse of, negligence, accident or inability to use any ATC product.

7. Technical Services

For technical support contact Adhesives Technology Corp. at (800) 892-1880.

8. Maintenance

None required.

9. Filing System

Additional product information and specifications are available either on line at www.atc.ws or contact Adhesives Technology at (800) 892-1880 to get copies mailed to you.

Actual user performance and data may differ due to variations of base material, installation procedures and personnel, weather conditions and other factors. Adhesives Technology Corp. reserves the right to change specifications or information printed in this Tech Data Sheet without notice or liability for these changes. Adhesives Technology Corp. will not be liable for any claim based on the use of data or other information printed in this Tech Data Sheet.